

U-CARA™

MULTI-FACE WALL SYSTEM



JOIN THE REVOLUTION with the U-Cara Advantage

Unilock is pushing design and technology forward to inspirational levels by combining easy installation with an ever-expanding pallet of design colors and finishes.

- | Seamlessly coordinate with Unilock pavers
- | Interchangeable fascia panels for creative flexibility
- | Site-specific engineering available for low or high walls
- | Create single-sided or double-sided walls

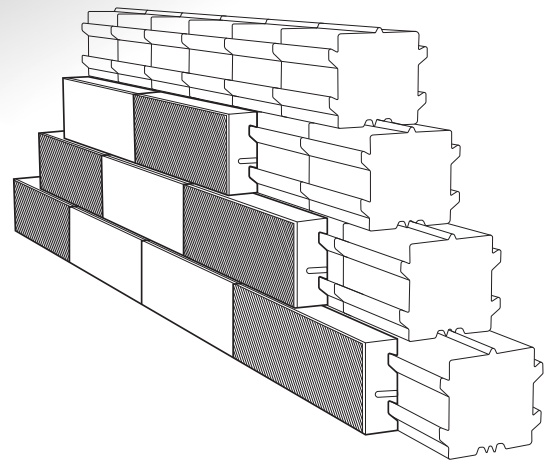

UNILOCK®

U-CARA™ DESIGN PALETTE

U-Cara fascia panels are available in a variety of colors and textures, which include exclusive **Unilock® EnduraColor finishes.**

UMBRIANO® FACE



FRENCH GREY



WINTER MARVEL



MIDNIGHT SKY



SUMMER WHEAT

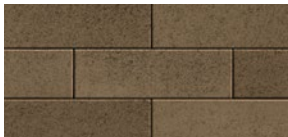

HARVEST BROWN

SERIES™ FACE



BLACK GRANITE



PEPPERED GRANITE

PITCHED FACE



ALMOND GROVE FUSION



BAVARIAN

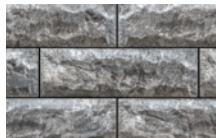

GRANITE FUSION

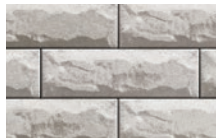

OPAL BLEND



RIVER



SIERRA

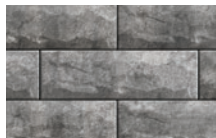

STEEL GREY



STEEL MOUNTAIN

SMOOTH PREMIER FACE

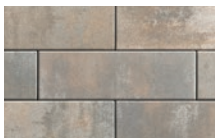

ALMOND GROVE FUSION



BAVARIAN



CREAM



GRANITE FUSION

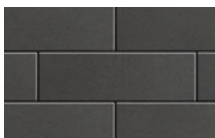

GRAPHITE

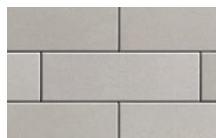

OPAL BLEND

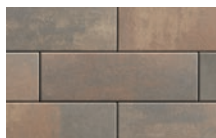

SIERRA

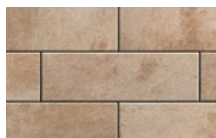

TUSCANY

TECHNICAL ADVANTAGES

ENDURACOLOR™
PLUS ARCHITECTURAL FINISHES

Refined surface and long-lasting color

EASYSOIL™ STAIN RESISTANCE - CF 90

Factory sealed to provide integral surface protection from stains

COLORFUSION™ TECHNOLOGY

Subtly mottled color finish

TECHNICAL ADVANTAGES

ENDURACOLOR™
PLUS ARCHITECTURAL FINISHES

Refined surface and long-lasting color

Granite, Quartz and Marble surface materials.

TECHNICAL ADVANTAGES

ENDURACOLOR™

Refined surface and long-lasting color

TECHNICAL ADVANTAGES

ENDURACOLOR™

Refined surface and long-lasting color

TWO COMPONENTS. ENDLESS POSSIBILITIES.

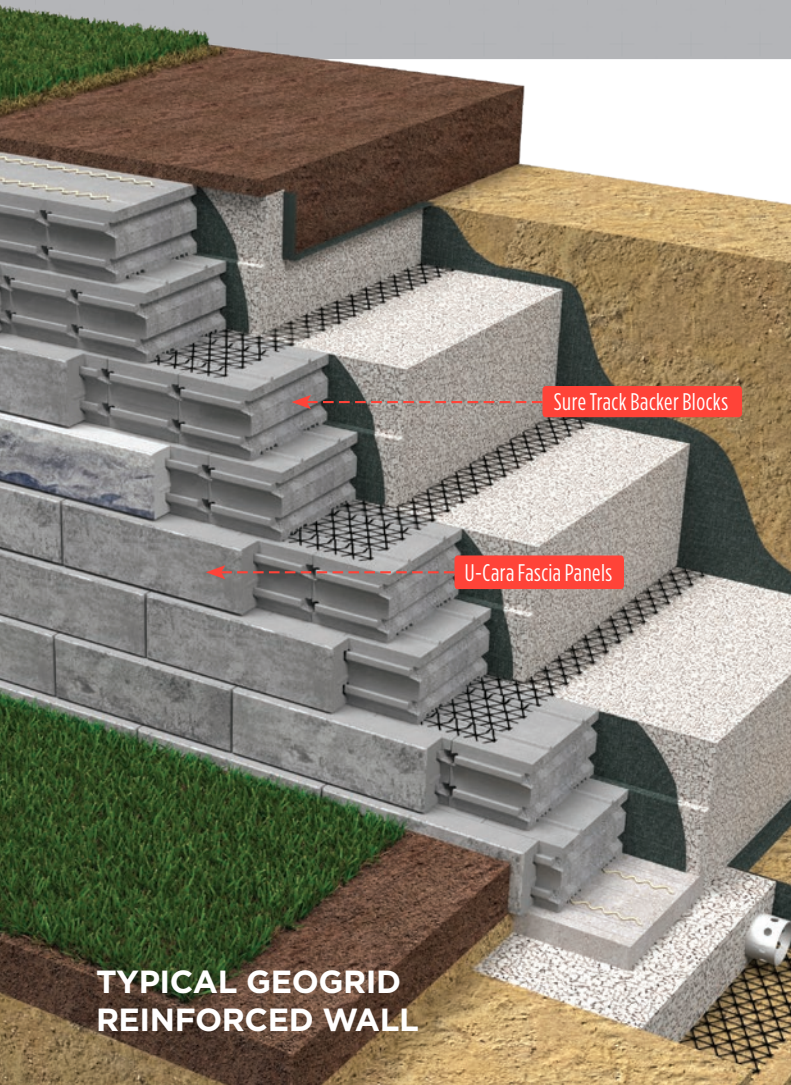

The U-Cara Multi-Face Wall System is a platform made up of several main components that provide a huge array of installation and design options.

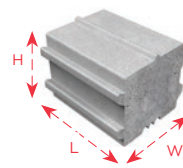

Standard Sure Track Backer Block
6" H x 8" L x 6" W
15 cm x 20 cm x 15 cm

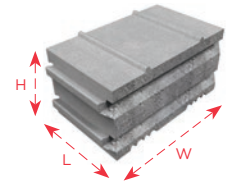

Large Sure Track Backer Block
6" H x 7" L x 12" W
15 cm x 17.5 cm x 30 cm

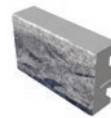

U-Cara Standard Fascia Half Panel
6" H x 9.25" L x 2.36" W
15 cm x 23.3 cm x 6 cm



U-Cara Closed-End Fascia Corner Panel
6" H x 20.9" L x 2.36" W
15 cm x 53 cm x 6 cm



U-Cara Standard Fascia Panel
6" H x 18.5" L x 2.36" W
15 cm x 46.6 cm x 6 cm



Sure Track Corner Insert
L = 2" (5cm)

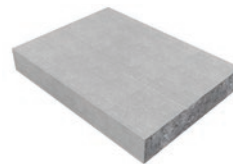

Universal Coping
2.75" H x 19" L x 14" W
7 cm x 48.2 cm x 35.5 cm



Universal Base Unit
2" H x 19" L x 14" W
5.5 cm x 48.2 cm x 35.5 cm

**TYPICAL GEOGRID
REINFORCED WALL**



To learn more about U-Cara, download the complete Installation and Engineering Manual at Unilock.com.

U-CARA U-DESIGN



U-Cara Panel Positioning with Sure Track

The patented U-Cara™ wall system gives you more design options for complete creative flexibility. That's because a U-Cara Fascia Panel can be placed anywhere on the Sure Track™ Backer Blocks, allowing for a variety of pattern, color and texture combinations not possible with other systems.

Sure Track backer blocks and U-Cara Fascia Panels are engineered for maximum flexibility, alignment and accuracy.



UNILOCK®